

# GERMANY F3 50QT-2 ( front disc brake, rear drum brake, case lengthen ) PARTS LIST

图1 风扇及导风系统分总成

FAN AND WIND LEADING COMP.

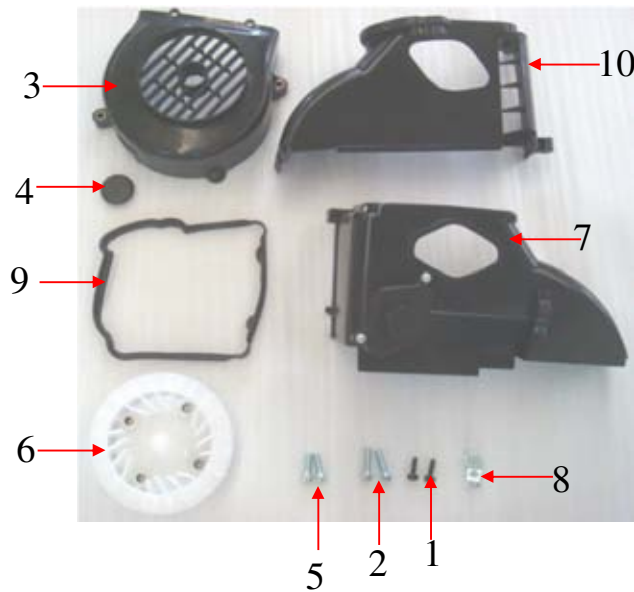

型号 TOTAL NO	序号 NO	图号	零部件编码 PART NO	英文名称 ENGLISH NAME
HS1P39QM	1	845-5-16	GB/T845-85	SCREW ST5*16
HS1P39QM	2	845-6-25	GB/T845-85	BOLT M6*25
HS1P39QM	3	19101-F23-0000	1P39QMB-00101	COVER,WIND LEADING
HS1P39QM	4	19108-F23-0000	1P39QMB-00102	BOUNG,RUBBER
HS1P39QM	5	16.06.5787	GB/T5787-86	BOLT M6*16
HS1P39QM	6	19110-F23-0000	1P39QMB-00103	FAN
HS1P39QM	7	19106-F23-0000	1P39QMB-00104	UPER COVER
HS1P39QM	8	91502-F21-0000	1P39QMB-00107	CLIP TUDE
HS1P39QM	9	19107-F23-0000	1P39QMB-00108	SEAL THROUD
HS1P39QM	10	19103-F23-0000	1P39QMB-00111	BOTTOM COVER

图2 气缸盖分总成

HEADER COVER COMP

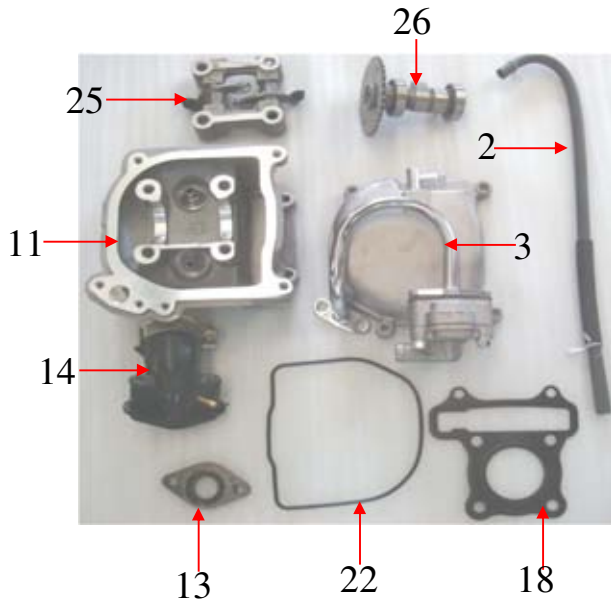

型号 TOTAL NO	序号 NO	图号	零部件编码 PART NO	英文名称 ENGLISH NAME
HS1P39QM	1	25.06.5787	GB/T5787-86	BOLT M6*25
HS1P39QM	2	18601-F21-0000	1P39QMB-00201	TUBE ASSY.,BREATHER
HS1P39QM	3	12300-F23-0000	1P39QMB-00210	COVER ASSY.,HEAD
HS1P39QM	4	33300-F21-0000	1P39QMB-00211	SPARK PLUG
HS1P39QM	5	14781-F21-0000	1P39QMB-00220-01	COTTER VALVE
HS1P39QM	6	14771-F21-0000	1P39QMB-00220-02	RETAINER,VALVE SPRING
HS1P39QM	7	14761-F23-0000	1P39QMB-00220-03	SPRING, VALVE INNER
HS1P39QM	8	14751-F23-0000	1P39QMB-00220-04	SPRING, VALVE OUTER
HS1P39QM	9	91104-F21-0000	1P39QMB-00220-05	SEAT,VALVE STEM
HS1P39QM	10	14775-F21-0000	1P39QMB-00220-06	SEAT, SPRING

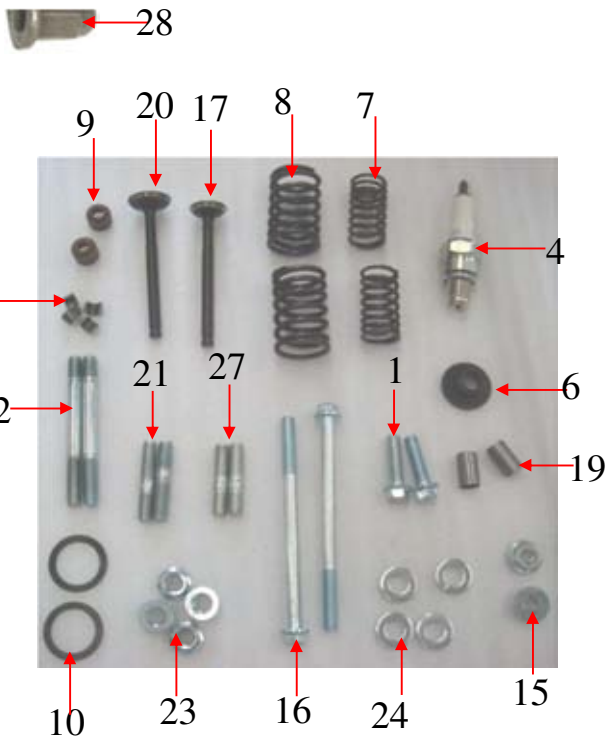

HS1P39QM	11	12200-F23B-0000	1P39QMB-00220-07	COVER HEAD ASSY.,CYLINDER
HS1P39QM	12	899-6-62	125-T0010-011	BOLT STUD M6*62
HS1P39QM	13	91220-F23-0000	1P39QMB-00221	INSULATOR CARB ASSY.
HS1P39QM	14	14800-F23-0000	1P39QMB-00222	PIPE ASSY.,INLET
HS1P39QM	15	6177.1-6-00	GB/T6177.1-2000	NUT M6
HS1P39QM	16	5787-6-85	GB/T5787-86	BOLT M6*85
HS1P39QM	17	14721-F23-0000	1P39QMB-00223	VALVE EXHAUST
HS1P39QM	18	91216-F23-0000	1P39QMB-00224	GASKET,CYLINDER HEAD
HS1P39QM	19	90803-F23-0000	GB/T119.1-2000	PIN DOWEL 8*14
HS1P39QM	20	14711-F23-0000	1P39QMB-00225	VALVE INLET
HS1P39QM	21	899-6-32	125-T0010-011	BOLT STUD M6*32
HS1P39QM	22	91204-F23-0000	1P39QMB-00227	RING,HEADER COVER SHROUD
HS1P39QM	23	GB3098.2-2000	1P39QMB-00228	NUT,M7
HS1P39QM	24	97.1-7-00	GB/T97.1-85	WASHER 7
HS1P39QM	25	12250-F23-0000	1P39QMB-00230	HOLDER ASSY.,CAM SHAFT
HS1P39QM	26	14100-F23B-0000	1P39QMB-00240	SHAFT COMP., CAM
HS1P39QM	27	899-6-28	125-T0010-011	BOLT STUD M6*28
HS1P39QM	28	12314-F23-0000	T0010-002	NUT M6*17



图3 气缸体分总成				
CYLINDER HEAD COMP				
型号	序号	图号	零部件编码	英文名称
TOTAL NO	NO		PART NO	ENGLISH NAME
HS1P39QM	1	14521-F21-0000	1P39QMB-00301	BOLT,PIVOT CHAIN TENSIONER
HS1P39QM	2	91206-F21-0000	GB/T97.1-85	O-RING 15*1.5
HS1P39QM	3	14520-F23-0000	1P39QMB-00302	TENSIONER CHAIN
HS1P39QM	4	14300-F23-0000	1P39QMB-00303	CHAIN,TIMER
HS1P39QM	5	14630-F23-0000	1P39QMB-00304	GUIDE COMP,CHAIN
HS1P39QM	6	18.06.5787	GB/T5787-86	BOLT M6*18
HS1P39QM	7	12100-F23-0000	1P39QMB-00305	CYLINDER ASSY.



HS1P39QM	8	14500-F23-0000	1P39QMB-00306	ADJUST,CHAIN
HS1P39QM	9	91218-F23-0000	1P39QMB-00307	GASKET,CHAIN ADJUST
HS1P39QM	10	90803-F23-0000	GB/T119.1-2000	PIN,DOWEL 8*14
HS1P39QM	11	91215-F23-0000	1P39QMB-00308	GASKET,CYLINDER

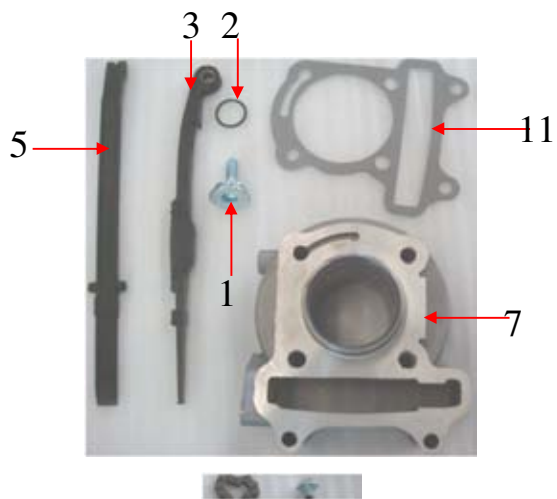
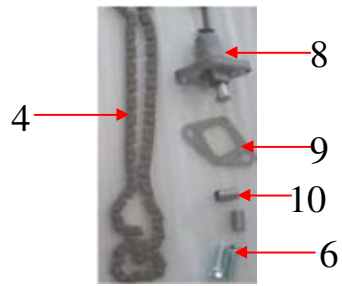

图4 右盖分总成				
COVER COMP.,R.				
型号 TOTAL NO	序号 NO	图号	零部件编码 PART NO	英文名称 ENGLISH NAME
HS1P39QM	1	15214-F21-0000	1P39QMB-00402	GAUGE,OIL LEVEL
HS1P39QM	2	91202-F21-0000	1P39QMB-00403	O-RING 18*3
HS1P39QM	3	91103-F23-0000	1P39QMB-00404	OIL SEAL 16.4*30*5
HS1P39QM	4	119.1-8-14	GB/T119.1-2000	PIN,DOWEL
HS1P39QM	5	91213-F23-0000	1P39QMB-00405	GASKET,R. CRANKCASE COVER
HS1P39QM	6	11300-F23-0000	1P39QMB-00406	COVER,R. CRANKCASE ASSY.,
HS1P39QM	7	15211-F21-0000	1P39QMB-00407	SCREEN,OIL FILTER
HS1P39QM	8	15213-F21-0000	1P39QMB-00408	SPRING,OIL FILTER SCREEN
HS1P39QM	9	91203-F21-0000	1P39QMB-00411	O-RING 30*3
HS1P39QM	10	15212-F21-0000	1P39QMB-00412	CAP , OIL FILTER SCREEN
HS1P39QM	11	5787-6-100	GB/T5787-86	BOLT M6*100
HS1P39QM	12	5787-6-85	GB/T5787-86	BOLT M6*85



图5 右箱体分总成				
CRANKCASE COMP.,R.				
型号 TOTAL NO	序号 NO	图号	零部件编码 PART NO	英文名称 ENGLISH NAME
HS1P39QM	1	24312-F23-0000	1P39QMB-00501	BEARING COLLAR
HS1P39QM	2	11102-F21-0000	1P39QMB-00502	BUSH,EDGING HANGER RUBBER
HS1P39QM	3	91212-F23-0000	1P39QMB-00503	GASKET, CRANKCASE R.

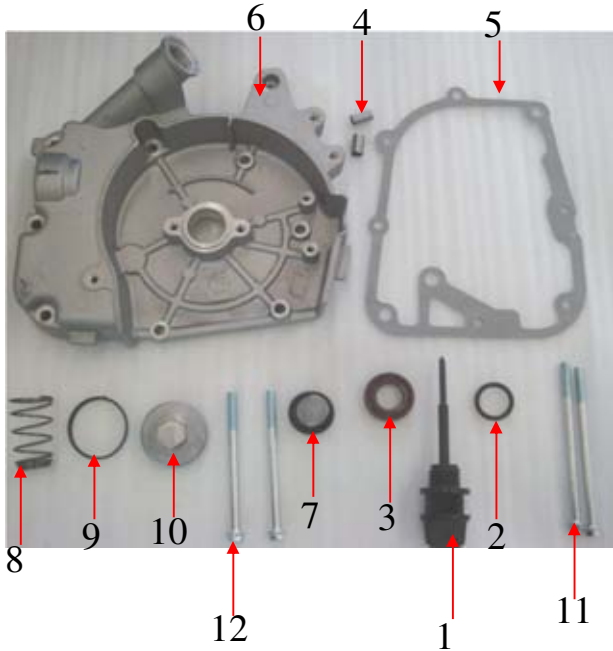
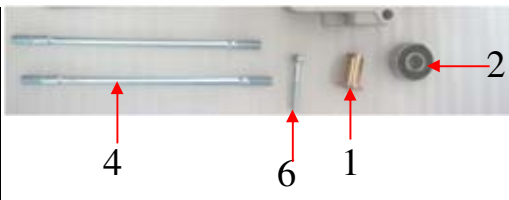

HS1P39QM	4	90031-F23-0000	125-T0010-011	BOLT,STUD M7*168
HS1P39QM	5	11200-F23-0000	1P39QMB-00505	CRANKCASE ASSY.,R
HS1P39QM	6	5787-6-45	GB/T5787-86	BOLT M6*45



图6-1 左箱体分总成				
CRANKCASE COMP., L.				
型号 TOTAL NO	序号 NO	图号	零部件编码 PART NO	英文名称 ENGLISH NAME
HS1P39QM	1	91211-F21-0000	1P39QMB-00601	O-RING 11.3*1.3
HS1P39QM	2	42206-F23-0000	1P39QMB-00602	CAM,RR. BRAKE
HS1P39QM	3	42201-F21-0000	1P39QMB-00603	SHOE ASSY.,RR. BRAKE
HS1P39QM	4	42202-F21-0000	1P39QMB-00604	SPRING,BRAKE SHOE
HS1P39QM	5	91104-F23-0000	1P39QMB-00610-01	PIN, BRAKE SHOE ANCHOR
HS1P39QM	6	91201-F21-0000	1P39QMB-00610-02	O-RING 7.5*1.5
HS1P39QM	7	22700-F23-0000	1P39QMB-00610-03	TRANSMISSION COVER
HS1P39QM	8	6177-8-00	1P39QMB-00610-04	NUT,M8
HS1P39QM	9	276-6201	1P39QMB-00610-05	BEARING RALL RADIAL 6201
HS1P39QM	10	6177.2-6004-2RS	1P39QMB-00610-06	BEARING RALL RADIAL 6004-2RS
HS1P39QM	11	91102-F21-0000	1P39QMB-00610-07	OIL SEAL 27*42*7
HS1P39QM	12	91221-F23-0000	1P39QMB-00610-08	GASKET,TRANSMISSION COVER
HS1P39QM	13	90802-F23-0000	GB/T119.1-2000	PIN,DOWEL 10*20
HS1P39QM	14	6187-16-00	GB/T6187-2000	NUT M16*1.5
HS1P39QM	15	22703-F23B-0000	1P39QMB-00620-01	SHAFT,FINAL
HS1P39QM	16	22704-F23B-0000	1P39QMB-00620-02	GEAR, FINAL
HS1P39QM	17	6170-10-00	GB/T6170-2000	NUT M10*1.25
HS1P39QM	18	22701-F23B-0000	1P39QMB-00620-03	SHAFT, DRIVE
HS1P39QM	19	22702-F23B-0000	1P39QMB-00620-04	GEAR AND SHAFT ASSY.,CENTER
HS1P39QM	20	97.1-12-00	GB/T97.1-85	WASHER 12.2*20*1.5
HS1P39QM	21	42207-F23-0000	1P39QMB-00622	ARM ASSY.,RR.BRAKE





24 25 26 32 31 27 30



图6-2 左箱体分总成

CRANKCASE COMP., L.

型号 TOTAL NO	序号 NO	图号	零部件编码 PART NO	英文名称 ENGLISH NAME
HS1P39QM	22	5787-6-32	GB/T5787-86	BOLT M6*32
HS1P39QM	23	11100-F23B-0000	1P39QMB-00630-01	CRANKCASE ASSY.,L.
HS1P39QM	24	276-6203	1P39QMB-00630-02	BEARING RALL RADIAL 6203
HS1P39QM	25	276-6201	1P39QMB-00630-03	BEARING RALL RADIAL 6201
HS1P39QM	26	276-6203A-42	1P39QMB-00630-04	BEARING RALL RADIAL 6203A-42
HS1P39QM	27	11103-F21-0000	1P39QMB-00630-06	BUSH,RR.CUSHION UNDER RUBBER
HS1P39QM	28	24311-F23-0000	1P39QMB-00630-07	COLLAR,STARTER
HS1P39QM	29	91103-F23-0000	1P39QMB-00630-08	OIL SEAL 17*30*6
HS1P39QM	30	24312-F23-0000	1P39QMB-00630-09	COLLAR, BEARING
HS1P39QM	31	11102-F21-0000	1P39QMB-00630-10	BUSH,ENGING HANGER RUBBER
HS1P39QM	32	90801-F21-0000	1P39QMB-00630-11	PIN,FIXUP
HS1P39QM	33	97.1-	1P39QMB-00630-12	WASHER,DRAIN PLUG
HS1P39QM	34	12.08.5787	GB/T5787-86	BOLT M8*12
HS1P39QM	35	5787-8-40	GB/T5787-86	BOLT M8*40
HS1P39QM	36	5787-8-35	GB/T5787-86	BOLT M8*35
HS1P39QM	37	5790-	125-T0010-012	BOLT,DRAIN PLUG
HS1P39QM	38	90032-F23-0000	125-T0010-011	BOLT,STUD M7*176
HS1P39QM	39	90803-F23-0000	GB/T119.1-2000	PIN,DOWEL
HS1P39QM	40	11207-F21-0000	1P39QMB-11107	OIL SEAL 19.8*30*5

图7 左盖分总成

COVER COMP.,L.



型号 TOTAL NO	序号 NO	图号	零部件编码 PART NO	英文名称 ENGLISH NAME
HS1P39QM	1	21700-F23-0000	1P39QMB-00710	DETENT AND GEAR ASSY,STARTER

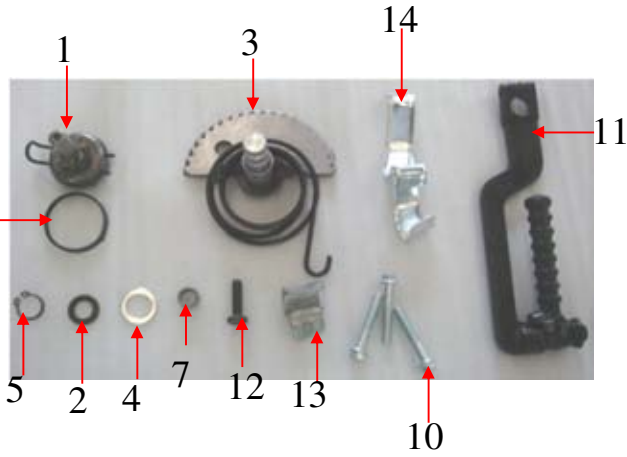

HS1P39QM	2	97.1-10-00	GB/T97.1-85	WASHER 1.0*10*18
HS1P39QM	3	21800-F23-0000	1P39QMB-00720	SHAFT ASSY.,KICK STARTER
HS1P39QM	4	97.1-14-00	GB/T97.1-85	WASHER 14*21*1.5
HS1P39QM	5	90701-F23-0000	GB/T893-86	CIRCLIP 14
HS1P39QM	6	14803-F23-0000	1P39QMB-00720-04	PLASTIC HOOP
HS1P39QM	7	24311-F23-0000	1P39QMB-00721	BUSH,STARTER
HS1P39QM	8	91214-F23B-0000	1P39QMB-00722	GASKET, COVER L.
HS1P39QM	9	11300-F23B-0000	1P39QMB-00723	COVER,L.
HS1P39QM	10	5787-6-35	GB/T5787-86	BOLT M6*35
HS1P39QM	11	21900-F23-0000	1P39QMB-00730	ARM ASSY,KICK STARTER
HS1P39QM	12	22.06.5787	GB/T5787-86	BOLT M6*22
HS1P39QM	13	91501-F23-0000	1P39QMB-00730-01	CLAMPER,BREATHER DRAIN TUBE
HS1P39QM	14	91504-F23-0000	1P39QMB-00730-02	CLAMPER,THROTTLE CABLE



图8 活塞连杆曲轴分总成

PISTON、CONNECTING ROD AND CRANKSHAFT COMP.

型号 TOTAL NO	序号 NO	图号	零部件编码 PART NO	英文名称 ENGLISH NAME
HS1P39QM	1	13120-F23-0000	1P39QMB-00810	RING SET ASSY.,PISTON(OIL)
HS1P39QM	2	13100-F23-0000	1P39QMB-00811	PISTON
HS1P39QM	3	91301-F23-0000	1P39QMB-00812	CIRCLIP,PIN OF PISTON
HS1P39QM	4	13111-F23-0000	1P39QMB-00813	PIN,PISTON
HS1P39QM	5	6170-12-00	GB/T6170-2000	NUT M12*1.25
HS1P39QM	6	97.1-12-00	GB/T97.1-85	WASHER 12
HS1P39QM	7	13200-F23-0000	1P39QMB-00820	CRANKSHFT ASSY.
HS1P39QM	8	6170-10-00	GB/T6170-2000	NUT M10*1.25

图9 无级变速系统分总成



TRANSMISSION COMP. CRANKSHAFT COMP.				
型号 TOTAL NO	序号 NO	图号	零部件编码 PART NO	英文名称 ENGLISH NAME
HS1P39QM	1	21202-F23B-0000	1P39QMB-00901	BELT DRIVE
HS1P39QM	2	21600-F23-0000	1P39QMB-00910	FACE COMP.,DRIVE
HS1P39QM	3	21100-F23B-0000	1P39QMB-00920-BT	PULLEY COMP.,DRIVER



图10 机油泵分总成/电起动分总成				
PUMP COMP.,OIL COMP./ELECTRICTY STARTER COMP.				
型号 TOTAL NO	序号 NO	图号	零部件编码 PART NO	英文名称 ENGLISH NAME
HS1P39QM	1	6177.1-6-00	GB/T6177.1-2000	NUT M6
HS1P39QM	2	15003-F23-0000	1P39QMB-01001	GEAR,OIL PUMP DRIVEN
HS1P39QM	3	25.06.5787	GB/T5787-86	BOLT M6*25
HS1P39QM	4	20.06.5787	GB/T5787-86	BOLT M6*20
HS1P39QM	5	15100-F23-0000	1P39QMB-01010	PUMP ASSY.,OIL
HS1P39QM	6	25.06.5787	GB/T5787-86	BOLT M6*25
HS1P39QM	7	31200-F23-0000	1P39QMB-01101	MOTOR,STARTER
HS1P39QM	8	24300-F23-0000	1P39QMB-01102	CLUTCH ASSY.,STARTER
HS1P39QM	9	119.1-8-11	GB/T119.1-2000	PIN,DOWEL
HS1P39QM	10	91201-F23-0000	1P39QMB-00610-02	O-RING 9*1.6



图11 磁电机及电装品分总成				
GENERATOR AND ELECTRICAL EQUIPMENT COMP.				
型号 TOTAL NO	序号 NO	图号	零部件编码 PART NO	英文名称 ENGLISH NAME
HS1P39QM	1	31102-F23-0000	1P39QMB-01210-02	STATOR ASSY.
HS1P39QM	2	31101-F23-0000	1P39QMB-01210-01	FLYWHEEL ASSY.
HS1P39QM	3	22.06.5787	GB/T5787-86	BOLT,M6*22



HS1P39QM	4	12.05.5787	GB/T5787-86	BOLT,M5*12



图12 化油器				
CARBURETOR				
型号 TOTAL NO	序号 NO	图号	零部件编码 PART NO	英文名称 ENGLISH NAME
HS1P39QM	1	16100-060-0200	1P39QMB-020	CARBURETOR



图13 方向把总成				
STEERING HANDLE ASSY				
型号 TOTAL NO	序号 NO	图号	零部件编码 PART NO	英文名称 ENGLISH NAME
HS50QT-2	1	61101-147-0000	50QT2-15005	STEERING HANDLE BAR
HS50QT-2	2	90208-145-0000	125-T0010-008	DISTANCE SLEEVE
HS50QT-2	3	5787-10-45	GB/T5787-86	BOLT M10*45
HS50QT-2	4	6187-10-00	GB/T6187-2000	NUT M10
HS50QT-2	5	44100-147-0100	150T5-33010	FR, HYDRAULIC BRAKE ASSY
HS50QT-2	6	44102-147-0000	150T5-33022	FRONT BRAKE DISK
HS50QT-2	7	90102-147-0000	125-T0010-005	SEAR SCREW, BRAKE DISK
HS50QT-2	8	5787-8-35	GB/T5787-86	BOLT M8*35
HS50QT-2	9	43700-060-0000	50QT12-27009	HANDLE BAR L
HS50QT-2	10	43800-060-0000	50QT12-27011	THROTTLE GRIP
HS50QT-2	11	61500-060-0000	50QT12-28001	CABLE THROTTLE
HS50QT-2	12	71130-147-0000	150T5-28002	CABLE CUSHION
HS50QT-2	13	43200-134-0000	125T12-28002	Rear brake cable
HS50QT-2	14	36330-147-0000	150T5-28003	MILEOMTERCABLE



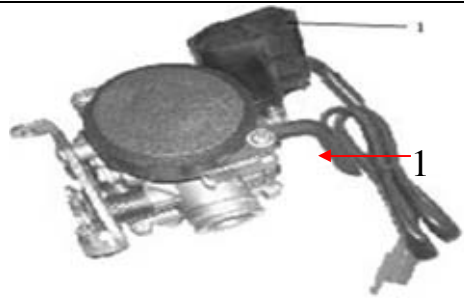

图14 前后减震器总成

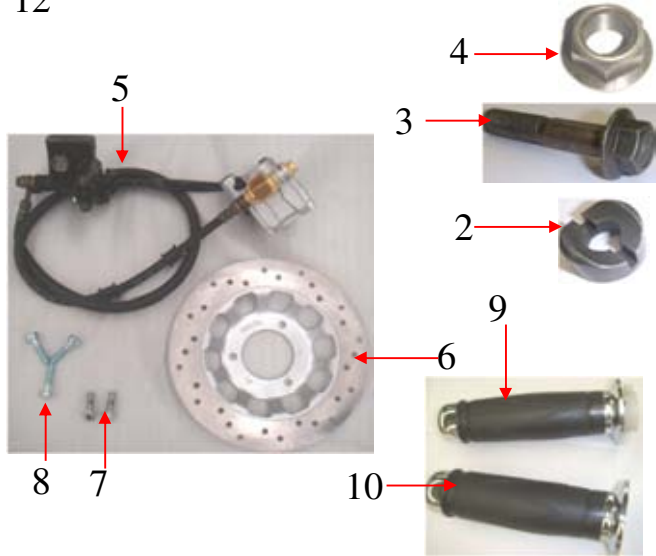
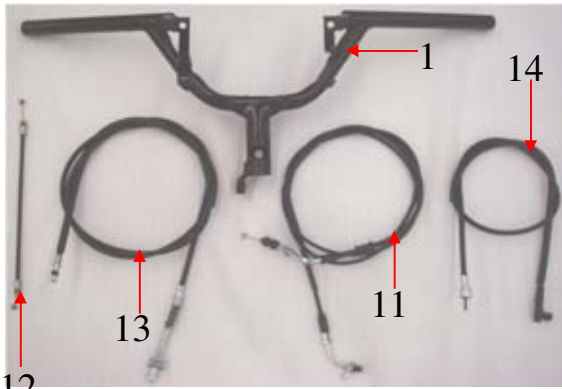
FR&RR SUSPENION ASSY

型号 TOTAL NO	序号 NO	图号	零部件编码 PART NO	英文名称 ENGLISH NAME
HS50QT-2	1	62121-147-0000	50QT2-15006	STEERING STEM ASSY
HS50QT-2	2	55310-147-0000	150T5-19010	FR. L SHOCK ABSORBER
HS50QT-2	3	55340-147-0000	150T5-19020	FR. R SHOCK ABSORBER
HS50QT-2	4	55510-147-0000	50QT2-19021	REAR SHOCK ABSORBER
HS50QT-2	5	62122-147-0000	150T5-16001	INNER RING BEARING UP
HS50QT-2	6	62123-147-0000	150T5-16002	EX RING BEARING BEARING UP
HS50QT-2	7	62124-147-0000	150T5-16003	STEEL BALL BREATHER
HS50QT-2	8	62125-147-0000	150T5-16004	WASHER
HS50QT-2	9	62126-147-0000	150T5-16005	UNDER COVER BEARING BOWL
HS50QT-2	10	62127-147-0000	150T5-16006	NUT LOCKING 1
HS50QT-2	11	62128-147-0000	150T5-16007	NUT LOCKING 2
HS50QT-2	12	54204-147-0000	50QT2-15012	
HS50QT-2	13	54205-147-0000	50QT2-15013	
HS50QT-2	14	125T12-19022	150T5-19022	Locker card
HS50QT-2	15	16.06.5787	GB/T5787-86	BOLT M6*16
HS50QT-2	16	12.06.5787	GB/T5787-86	BOLT M6*12
HS50QT-2	17	5783-10-35	GB/T5783-2000	BOLT M10*35
HS50QT-2	18	5787-10-40	GB/T5787-86	BOLT M10*40

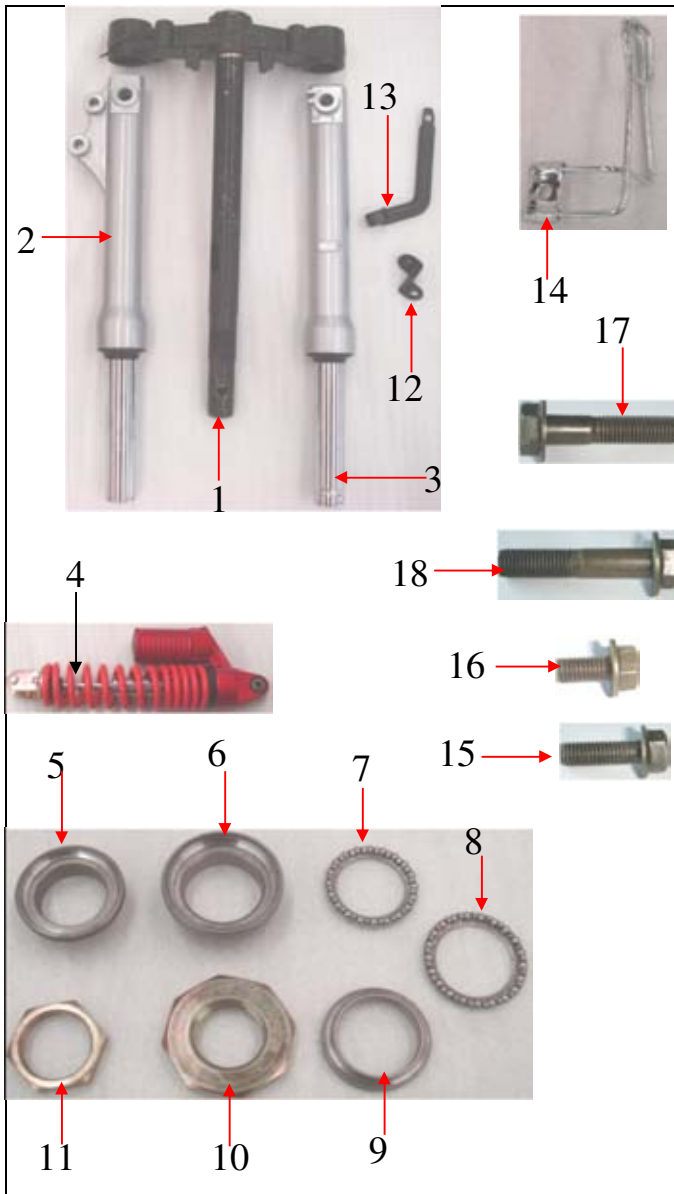

图15 前后轮总成

FR&RR WHEEL ASSY

型号 TOTAL NO	序号 NO	图号	零部件编码 PART NO	英文名称 ENGLISH NAME
HS50QT-2	1	41160-147-0100	50QT2-T18001	FRONT RR.TYPE(120/70-12)

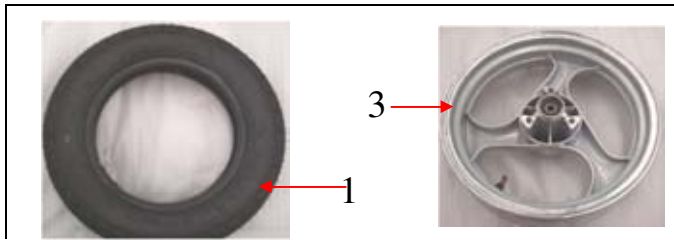
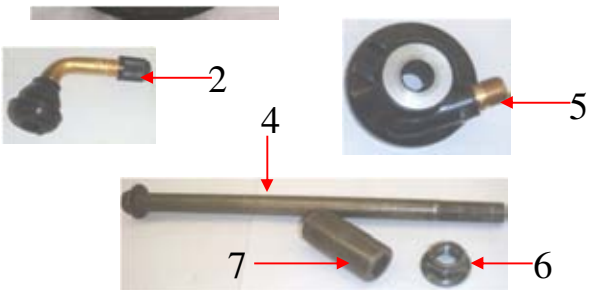

HS50QT-2	2	41120-145-0000	125T-18002	VALVE
HS50QT-2	3	41110-147-0100	50QT12-17001JD	RIM FRONT WHEEL
HS50QT-2	4	90206-147-0000	GB/T5787-86	FR. AXLE M12*230
HS50QT-2	5	36510-147-0000	150T5-20010	COUNTER
HS50QT-2	6	6187-12-00	GB/T6187-2000	NUT M12
HS50QT-2	7	90207-147-0000	125-T0010-004	SPACERΦ12.5*Φ20*41



图16 车架总成 (FRAME ASSY)				
型号 TOTAL NO	序号 NO	图号	零部件编码 PART NO	英文名称 ENGLISH NAME
HS50QT-2	1	51101-147-0000	50QT2-15001	MAIN FRAME
HS50QT-2	2	54272-147-0000	50QT2-15007	HOLDER HORN
HS50QT-2	3	54301-147-0000	50QT2-15002	CRADLE
HS50QT-2	4	85717-147-0000	50QT2-15008	CUSHION LOCK BASE
HS50QT-2	5	54201-147-0000	50QT2-15009	
HS50QT-2	6	54202-147-0000	50QT2-15011	
HS50QT-2	7	92114-147-0000	125T-T0025	NAMEPLATE
HS50QT-2	8	5787-6-35	GB/T5787-86	BOLT M6*35
HS50QT-2	9	6177.1-6-00	GB/T6177.1	NUT M6
HS50QT-2	10	5787-10-40	GB/T5787-86	BOLT M10*40
HS50QT-2	11	6187-10-00	GB/T6187-2000	NUT M10
HS50QT-2	12	90206-147-0000	GB/T5787-86	SHAFT CRADLE M10*230
HS50QT-2	13	12.06.5787	GB/T5787-86	BOLT M6*12
HS50QT-2	14	16.06.5787	GB/T5787-86	BOLT M6*16



图17 油箱总成				

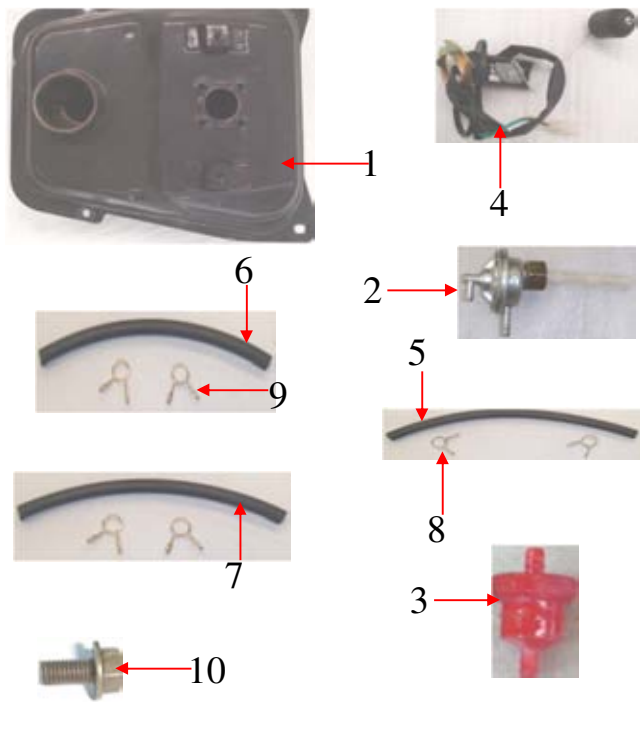

FUEL TANK ASSY				
型号 TOTAL NO	序号 NO	图号	零部件编码 PART NO	英文名称 ENGLISH NAME
HS50QT-2	1	81101-147-0000	50QT2-22001	FUEL TANK
HS50QT-2	2	81410-060-0000	125T-T0031	FUEL COCK
HS50QT-2	3	16610-145-0000	125T-T0032	FILTER
HS50QT-2	4	36210-147-0000	150T5-24020	FUEL SENSOR
HS50QT-2	5	16507-145-0000	125T-T0011	VACVUM PIPE
HS50QT-2	6	16501-145-0000	125T-T0012	TUBE 1
HS50QT-2	7	16501-145-0000	125T-T0012	TUBE 2
HS50QT-2	8	90401-145-0000	125T-T0013	RING Φ7*1
HS50QT-2	9	90402-145-0000	125T-T0014	RING Φ8*1
HS50QT-2	10	12.06.5787	GB/T5787-86	BOLT M6*12



图18 座垫、空气滤清器、后货架总成				
FUEL AND AIR FILTER ASSY				
型号 TOTAL NO	序号 NO	图号	零部件编码 PART NO	英文名称 ENGLISH NAME
HS50QT-2	1	85200-060-0200	50QT12-33010	MIRROR ASSY
HS50QT-2	2	17100-147-0000	50QT12-31010JC	AIR CLEANER ASSY
HS50QT-2	3	19872-060-0000	1P39QMB-002	AIR PIPE
HS50QT-2	4	71100-147-0000	50QT2-30010	SADDLE
HS50QT-2	5	85100-145-0000	125T-T0018	KIT SET
HS50QT-2	6	72712-1470000	50QT2-15015	
HS50QT-2	7	72711-147-0000	150T5-15016	RR. CARRIER
HS50QT-2	8	90207-147-0000	125-T0010-004	SPACERØ6.5*Ø12*6
HS50QT-2	9	25.06.5787	GB/T5787-86	BOLT M6*25



HS50QT-2	10	30.06.5787	GB/T5787-86	BOLT M6*30
HS50QT-2	11	16.06.5787	GB/T5787-86	BOLT M6*16
HS50QT-2	12	90102-147-0000	125-T0010-005	SETTING SCREW M8*40,REAR BRAKE
HS50QT-2	13	90102-147-0000	125-T0010-005	SETTING SCREW M8*45,REAR BRAKE

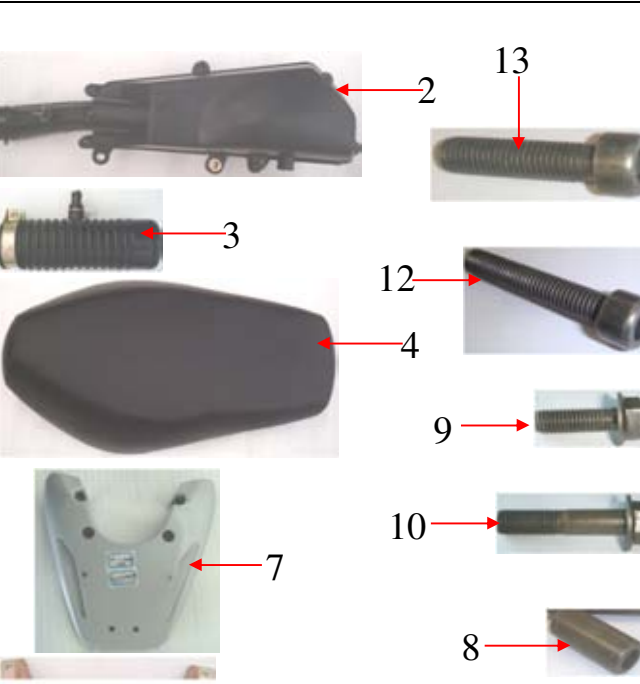
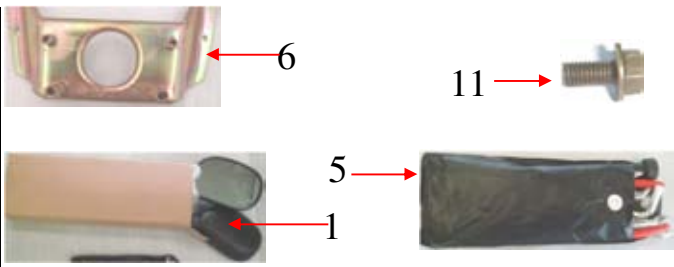

图19 消声器总成				
MUFFLER ASSY				
型号	序号	图号	零部件编码	英文名称
TOTAL NO	NO		PART NO	ENGLISH NAME
HS50QT-2	1	18120-147-0200	50QT2-21010	MUFFLER
HS50QT-2	2	18112-060-0000	50QT12-21010-004	GASKET
HS50QT-2	3	90305-145-0000	125-T0010-002	NUT M6
HS50QT-2	4	5787-8-40	GB/T5787-86	BOLT M8*40
HS50QT-2	5	5787-8-45	GB/T5787-86	BOLT M8*45



图20 主撑、边撑总成				
MAIN&SIDE STAND ASSY				
型号	序号	图号	零部件编码	英文名称
TOTAL NO	NO		PART NO	ENGLISH NAME
HS50QT-2	1	54401-147-0000	50QT2-15004	MAIN STAND
HS50QT-2	2	91405-147-0000	50QT2-29002	SPRING MAIN STAND
HS50QT-2	3	90201-147-0000	125-T0010-018	HEXAGON BOLT M8
HS50QT-2	4	96-	GB/T96-85	WASHER PLAIN Ø8.5*20*1.5
HS50QT-2	5	91-2.5-16	GB/T91-2000	PLACKET PIN M2.5*16
HS50QT-2	6	54501-147-0000	50QT2-15003	SIDE STAND
HS50QT-2	7	91403-147-0000	50QT2-29001	SPRING SIDE STAND
HS50QT-2	8	90104-147-0000	125-T0010-003	BOLT SIDE STAND M8*22*9



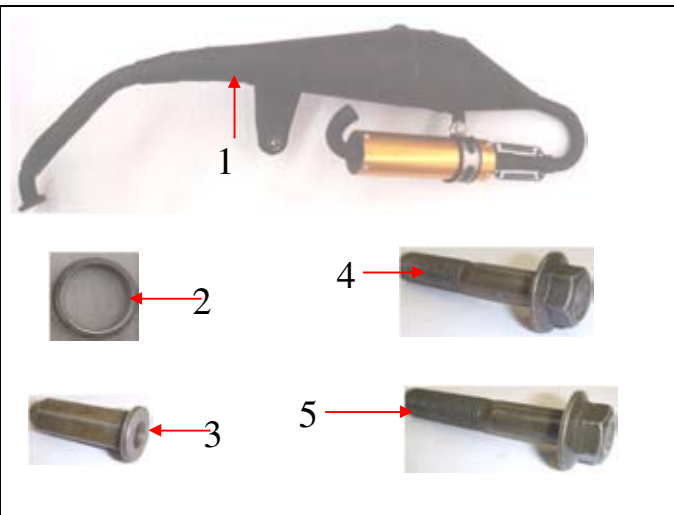

HS50QT-2	9	19871-060-0000	1P39QMB-001	VENT-PIPE
HS50QT-2	10	54311-147-0000	50QT2-27001	CUSHHION WASHER
HS50QT-2	11	54402-147-0000	50QT2-27002	CUSHION RUBBER

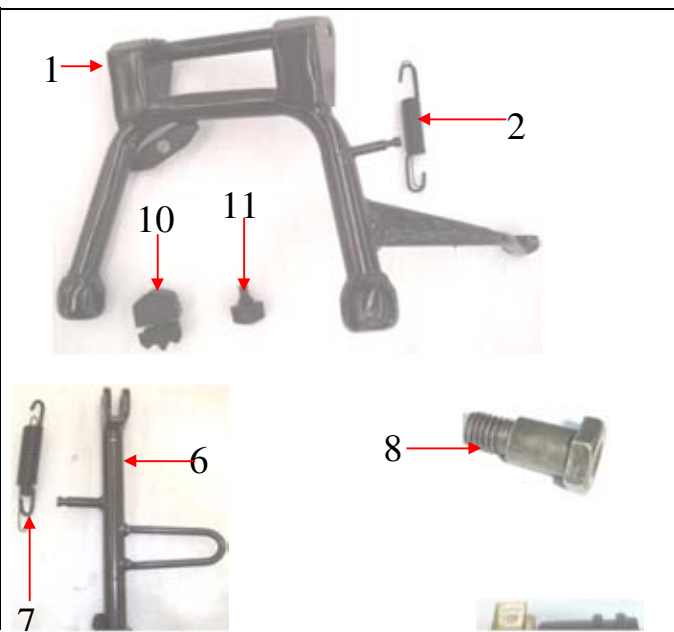
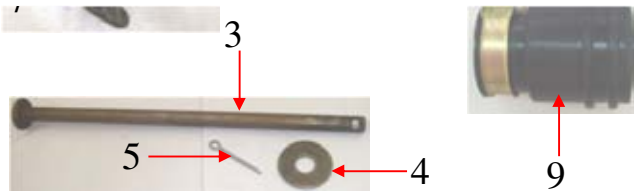

图21 电器总成

ELECTRIC APPLIANCE ASSY

型号 TOTAL NO	序号 NO	图号	零部件编码 PART NO	英文名称 ENGLISH NAME
HS50QT-2	1	34600-145-0000	125T-T0002	RELAY
HS50QT-2	2	33201-060-0000	1P39QMB-005	C.D.I
HS50QT-2	3	32101-060-0000	50QT12-38002	RECTIFIER
HS50QT-2	4	35200-147-0200	50QT2-13020	TAIL LIGHT
HS50QT-2	5	34841-145-0200	50QT2-14002	REAR REFLECTOR
HS50QT-2	6	35500-147-0200	50QT2-13060	REAR TURN LEFT LIGHT
HS50QT-2	7	35600-147-0200	50QT2-13070	REAR TURN Right LIGHT
HS50QT-2	8	35210-147-0200	50QT2-13080	
HS50QT-2	9	35100-147-0200	50QT2-13010	HEAD LIGHT
HS50QT-2	10	36120-147-0400	150T5-24010dd	SPEEDOMETER
HS50QT-2	11	35300-147-0200	50QT2-13040	FR L. TURNNING LIGHT
HS50QT-2	12	35400-147-0200	50QT2-13050	FR. R. TURNNING LIGHT
HS50QT-2	13	5787-616	GB/T5787-86	BOLT M6*16
HS50QT-2	14	845-4.2-12	GB/T845-85	SCREW TAPPINGST4.2*12
HS50QT-2	15	823-5-16	GB/T823-88	SCREW M5*16
HS50QT-2	16	6170-5-00	GB/T6170	NUT M 5
HS50QT-2	17	97.1-6-00	GB/T97.1-85	WASHER 6
HS50QT-2	18	93-6-00	GB/T93-87	
HS50QT-2	19	845-4.8-12	GB/T845-85	SCREW TAPPINGST4.8*12



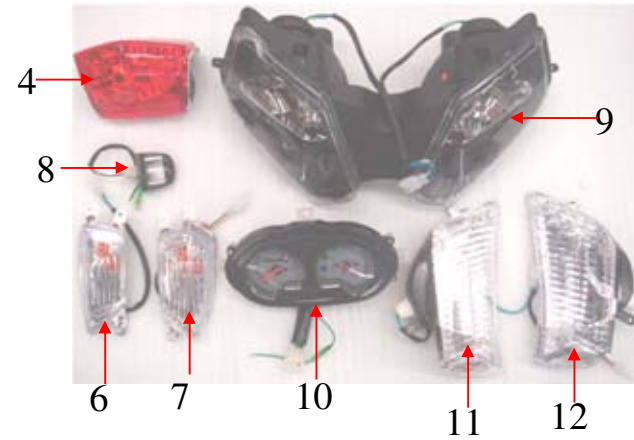
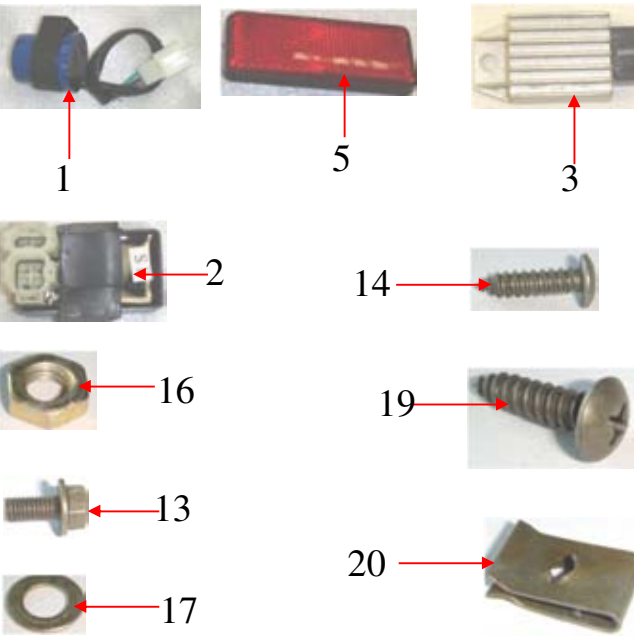

HS50QT-2	20	90316-145-0000	125-T0010-001	CLIP ST4.8

图22 电器总成

ELECTRIC APPLIANCE ASSY

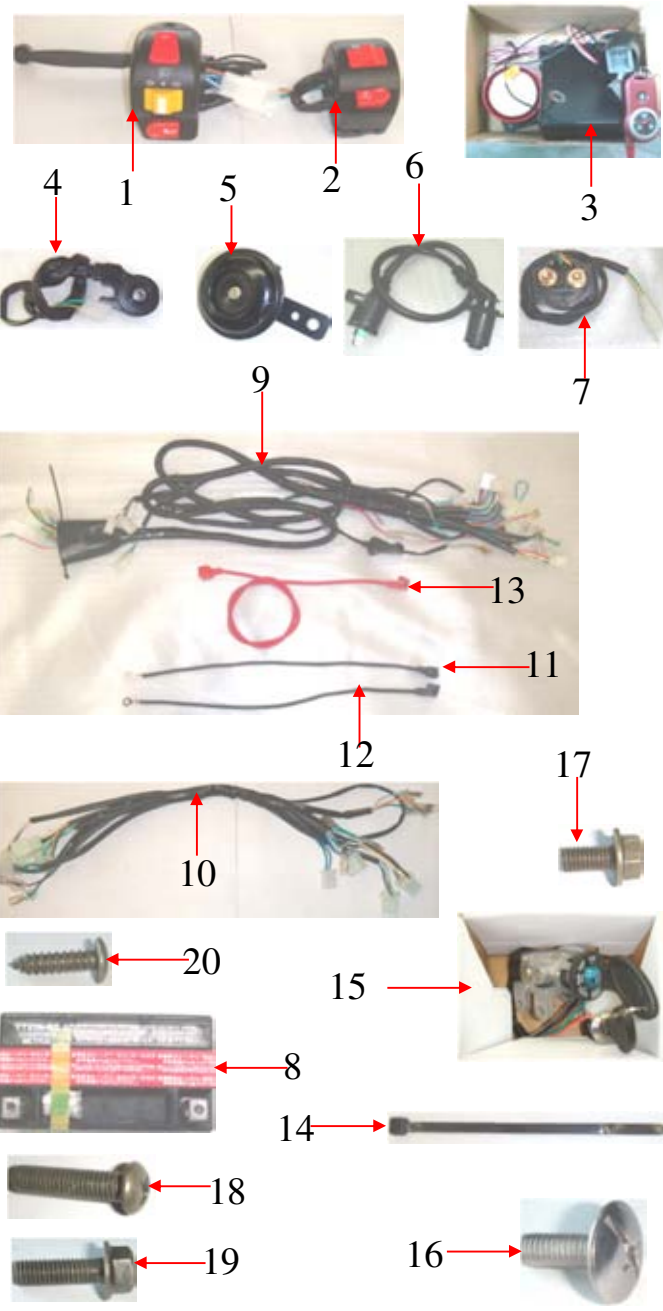

型号 TOTAL NO	序号 NO	图号	零部件编码 PART NO	英文名称 ENGLISH NAME
HS50QT-2	1	37410-060-0100	50QT12-25010	SWITCH, LEFT
HS50QT-2	2	37510-060-0100	50QT12-25020	SWITCH, RIGHT
HS50QT-2	3	34900-147-0000	125T-T0030	BURGLERY DEFENDER
HS50QT-2	4	37220-145-0000	125T-T0001	SWITCH, FLAMEOUT
HS50QT-2	5	34500-145-0200	125T-T0003	HORN
HS50QT-2	6	33100-060-0000	1P39QMB-006	IGNITION COIL COMP
HS50QT-2	7	37710-060-0000	50QT12-38001	RELAY
HS50QT-2	8	32200-060-0000	50QT12-38003	BATTERY
HS50QT-2	9	34110-147-0000	50QT2-23010	HARDNEES WIRE
HS50QT-2	10	34120-147-0000	50QT2-23011	SIDE WIRE
HS50QT-2	11	34101-147-0000	50QT2-23012	GROUND WIRE .A
HS50QT-2	12	34101-147-0000	50QT2-23013	GROUND WIRE .B
HS50QT-2	13	34102-147-0000	50QT2-23014	POWER WIRE
HS50QT-2	14	91524-145-0000	125T-T0009	
HS50QT-2	15	85700-147-0000	150T5-26010	ALL LOCKS
HS50QT-2	16	818-6-16	GB/T818-88	BOLT M6*16
HS50QT-2	17	12.06.5787	GB/T5787-86	BOLT M6*12
HS50QT-2	18	823-6-20	GB/T823-88	SCREW M6*20
HS50QT-2	19	16.06.5787	GB/T5787-86	BOLT M6*16
HS50QT-2	20	845-3.9-9	GB/T845-85	SCREW TAPPINGST3.9*9



图23 塑料件

PLASTIC PARTS

型号 TOTAL NO	序号 NO	图号	零部件编码 PART NO	英文名称 ENGLISH NAME
HS50QT-2	1	82521-147-0000	50QT2-12016	RR COVER SPEEDOMETER
HS50QT-2	2	82171-147-0000	50QT2-12012	FR. MUOGUARO, FR. WHEEL
HS50QT-2	3	90603-145-0000	50QT2-27003	WASHER
HS50QT-2	4	82802-147-0000	50QT2-12015	BOTTOM COVER
HS50QT-2	5	82133-147-0000	50QT2-12024	COVER MIDDLE
HS50QT-2	6	82134-147-0000	50QT2-12025	CENTER COVER
HS50QT-2	7	34821-145-0200	50QT2-14001	SIDE REFLECTOR
HS50QT-2	8	823-5-16	GB/T823-88	SCREW M5*16
HS50QT-2	9	97.1-	GB/T97.1-85	WASHER PLAIN Φ5MM
HS50QT-2	10	845-4.2-12	GB/T845-85	SCREW TAPPING ST4.2*12
HS50QT-2	11	818-6-16	GB/T818-88	BOLT M6*16
HS50QT-2	12	12.06.5787	GB/T5787-86	BOLTM6*12
HS50QT-2	13	90316-145-0000	125-T0010-001	CLIP ST4.8
HS50QT-2	14	845-4.8-16	GB/845-85	SCREW TAPPING ST4.8*16
HS50QT-2	15	6177.1-6-00	GB/T6177.1	NUT M6
HS50QT-2	16	97.1-	GB/T97.1-85	WASHER PLAIN Φ6MM
HS50QT-2	17	93-6-00	GB/T93-87	
HS50QT-2	18	82201-147-0000	50QT2-12027	REAR WHEEL FENDER
HS50QT-2	19	82203-147-0000	50QT2-12028	RELAY



图24 塑料件

PLASTIC PARTS

型号 TOTAL NO	序号 NO	图号	零部件编码 PART NO	英文名称 ENGLISH NAME
HS50QT-2	1	82301-147-0000	50QT2-12009	REAR LEFT SIDE PLATE
HS50QT-2	2	82401-147-0000	50QT2-12011	REAR RIGHT SIDE PLATE
HS50QT-2	3	82211-147-0000	50QT2-12014	REAR CENTER CONNECTING PLATE

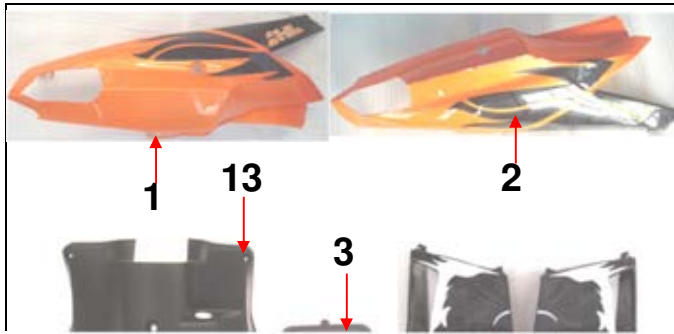
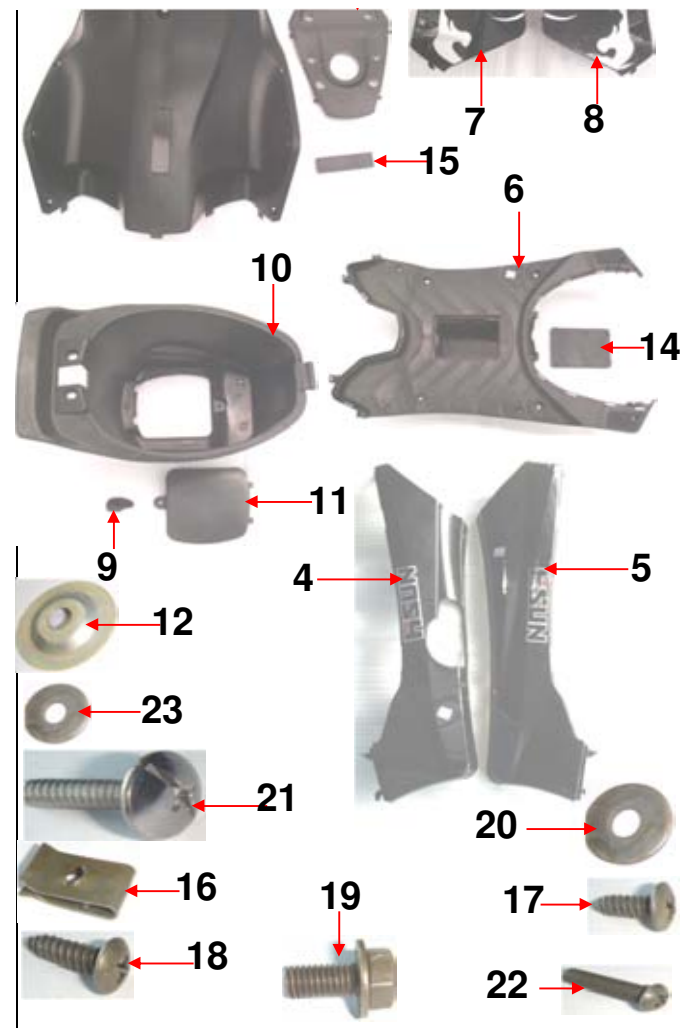

HS50QT-2	4	83201-147-0000	50QT2-12007	Left plastic plate
HS50QT-2	5	83202-147-0000	50QT2-12008	Right plastic plate
HS50QT-2	6	82731-147-0000	50QT2-12019	PEDAL
HS50QT-2	7	83204-147-0000	50QT2-12005	FRONT LEFT PROTECTION PIECE
HS50QT-2	8	83205-147-0000	50QT2-12006	FRONT RIGHT PROTECTION PIECE
HS50QT-2	9	82144-147-0000	50QT2-12026	HELMET HANG HOOK COMP
HS50QT-2	10	82131-147-0000	50QT2-12022	GOODS CASE
HS50QT-2	11	82132-147-0000	50QT2-12023	GOODS CASE BOTTOM COVER
HS50QT-2	12	90605-147-0000	50QT2-15014	
HS50QT-2	13	82141-147-0000	50QT2-12017	FRONT DOCUMENT CASE
HS50QT-2	14	82732-147-0000	50QT2-12021	Battery cover
HS50QT-2	15	82143-147-0000	50QT2-12018	VIN NUMBER COVER
HS50QT-2	16	90316-145-0000	125-T0010-001	CLIP ST4.8
HS50QT-2	17	845-4.2-12	GB/T845-85	TAPPING SCREW ST4.2*12
HS50QT-2	18	845-4.8-16	GB/T845-85	TAPPING SCREW ST4.8*16
HS50QT-2	19	16.06.5787	GB/T5787-86	BOLT M6*16
HS50QT-2	20	96-	GB/T96-85	WASHER PLAIN Φ6MM
HS50QT-2	21	818-6-30	GB/T818-88	BOLT M6*30
HS50QT-2	22	823-6-16	GB/T823-88	SCREW M6*16
HS50QT-2	23	97.1-	GB/T97.1-85	WASHER PLAIN Φ6MM



图25 塑料件				
FIG28(PLASTIC PARTS)				
型号	序号	图号	零部件编码	英文名称
TOTAL NO	NO		PART NO	ENGLISH NAME
HS50QT-2	1	82511-147-0000	50QT2-12001	HEAD COVER FRONT
HS50QT-2	2	82513-147-0000	50QT2-12002	FRONT DECORATION PLATE
HS50QT-2	3	82512-147-0000	50QT2-12013	DISK BRAKE COVER
HS50QT-2	4	90501-145-0000	125T15-27008	PLASTIC SCREW
HS50QT-2	5	845-4.8-16	GB/T845-85	TAPPING SCREW ST4.8*16
HS50QT-2	6	82111-147-0000	50QT2-12003	FRONT COVER



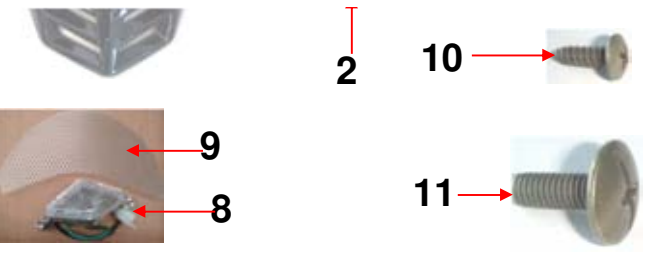

HS50QT-2	7	82114-147-0000	50QT2-12004	FRONT DECORATION PIECE
HS50QT-2	8	35820-147-0300	50QT2-13030	FRONT DEMOCRATIVE LIGHTS
HS50QT-2	9	82117-147-0000	50QT2-12029	
HS50QT-2	10	845-4.2-12	GB/T845-85	TAPPING SCREW ST4.2*12
HS50QT-2	11	818-6-16	GB/T818-88	BOLT M6*16

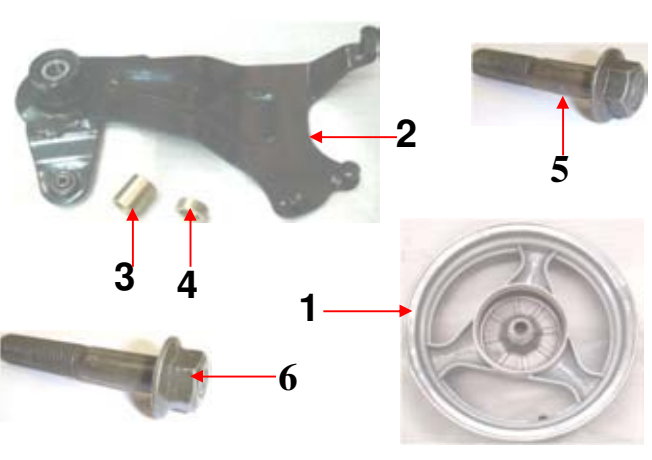

图26 后轮圈、消声器连接板总成				
REAR WHEELGASKET				
型号	序号	图号	零部件编码	英文名称
TOTAL NO	NO		PART NO	ENGLISH NAME
HS50QT-2	1	41210-147-0100	50QT12-17002JD	REAR WHEELGASKET
HS50QT-2	2	18303-147-0100	50QT2-15017	REAR CONNECTINGPLATE
HS50QT-2	3	90207-147-0000	125-T0010-004	SPACERΦ17*Φ25*30
HS50QT-2	4	90207-147-0000	125-T0010-004	SPACERΦ17*Φ25*9
HS50QT-2	5	5787-8-45	GB/T5787-86	BOLT M8*45
HS50QT-2	6	5787-8-55	GB/T5787-86	BOLT M8*55

